

## SCHOTTKY BARRIER RECTIFIER

### Features

- 3A Schottky barrier diode
- Schottky barrier rectifier
- Guarding protection
- Low forward voltage
- Reverse energy tested
- High current capability
- Extremely low thermal resistance

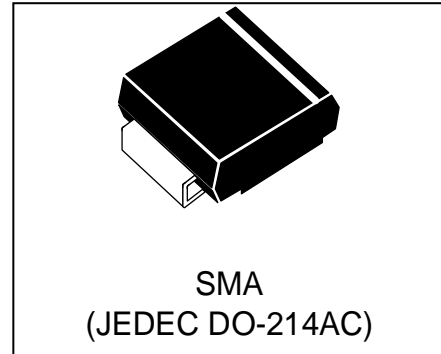

### Mechanical Data

- Case: SMA(JEDEC DO-214AC),molded plastic body
- Mounting position: any
- Polarity: Color band denotes cathode end

### Absolute Maximum Ratings and Electronics characteristics

Ratings@25°C ambient temperature unless otherwise specified

Parameter	Symbol	Value	UNITS
Maximum repetitive peak reverse voltage	$V_{RRM}$	40	V
Maximum RMS voltage	$V_{RMS}$	28	V
Maximum DC blocking voltage	$V_{DC}$	40	V
Maximum average forward rectified current	$I_{F(AV)}$	3	A
Peak forward surge current 8.3ms single half-sine-wave @60Hz	$I_{FSM}$	80	A
Maximum instantaneous forward voltage at $I_F=3.0A$	$V_F$	0.45	V
Maximum DC reverse current at rated DC blocking voltage	$I_R$	0.3 5	mA
Typical thermal resistance(junction to ambient) <sup>(1)</sup>	$R_{\theta JA}$	60	°C/W
Operating temperature range	$T_J$	-55 ~ +150	°C
Storage temperature range	$T_{STG}$	-55 ~ +150	°C

(1) P.C.B. mounted with 2.0" X 2.0" (5 X 5 cm) copper pad areas.

Typical characteristics (Ta=25°C, unless otherwise noted)

Fig.1 Forward Current Derating Curve

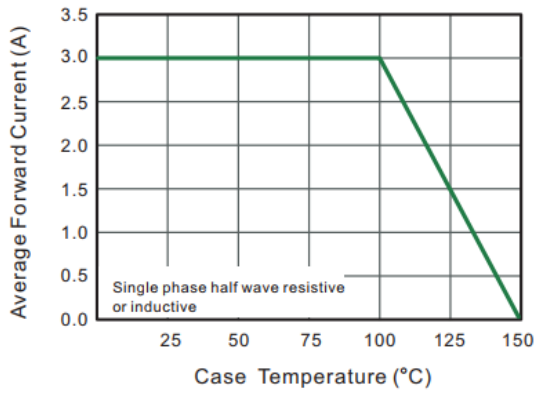

Fig.2 Typical Reverse Characteristics

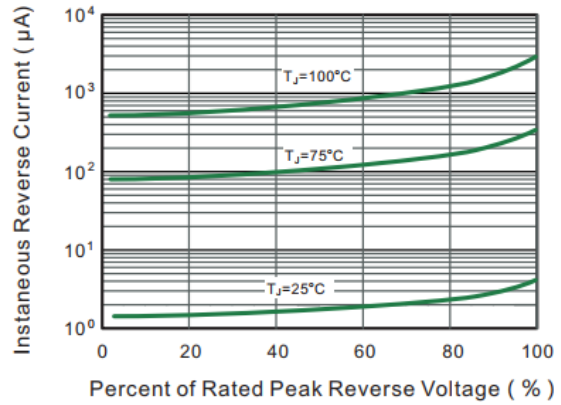

Fig.3 Typical Forward Characteristic

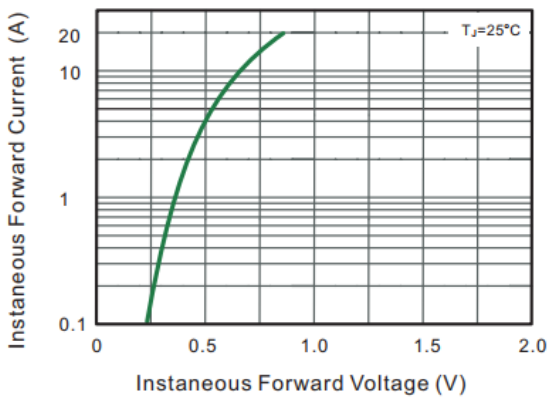
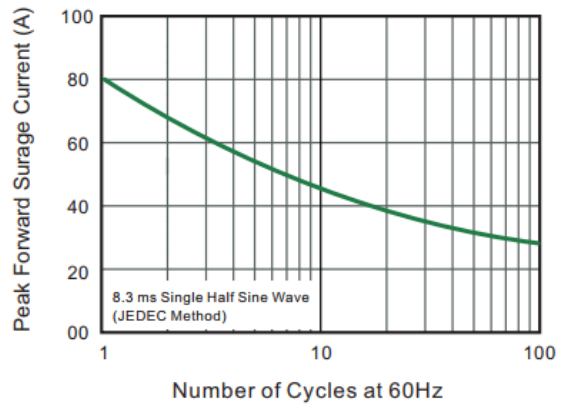
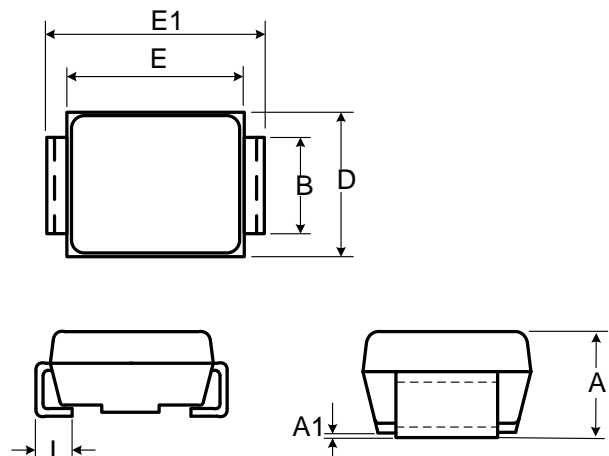

Fig.4 Maximum Non-Repetitive Peak Forward Surge Current



Outline Drawing

Ref. (mm)	Millimeters	
	Min.	Max.
A	1.900	2.300
A1	-	0.300
B	1.250	1.650
E	3.950	4.750
E1	4.700	5.280
D	2.300	2.830
L	0.760	1.520



## Recommended Solder Pad Layout

DIM(mm)	MILLIMETERS
A	2.30
B	1.80
C	2.10

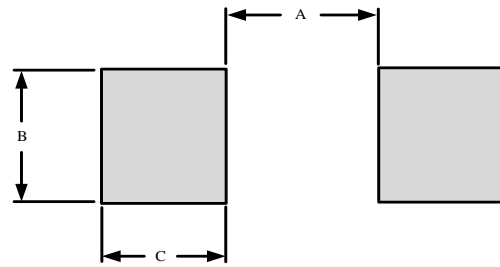

## Marking Code

Part Number	WSR4003AL
Marking Code	SSL34

## Package Information

**Tape & Reel:** 5000 pcs.

## Contact Information

No.1001, Shiwan(7) Road, Pudong District, Shanghai, P.R.China.201207

Tel: 021-68969993 Fax: 86-21-50757680 Email: market@way-on.com

WAYON website: <http://www.way-on.com>

For additional information, please contact your local Sales Representative.

**WAYON**® is registered trademarks of Wayon Corporation.

*Specifications are subject to change without notice.*

*The device characteristics and parameters in this data sheet can and do vary in different applications and actual device performance may vary over time. Users should verify actual device performance in their specific applications.*